



# DXN Modules

**Our turnkey prefabricated modular data centre solutions are scalable, purpose-built and rapidly deployable globally with full maintenance and support.**

DXN Modules provides a complete data centre solution including power systems, cooling systems, power distribution systems, cable trays, fibre trays, fire detection and suppression systems, structured cabling, lighting, access control, CCTV security systems and complete data centre monitoring solutions.

DXN Modular data centres can be custom designed for a wide range of EDGE deployments from colocation

edge data centres to remote micro edge data centres. DXN Modules provides the ability to create open white space modules from as small as 2 Racks to 500 Racks in a data hall.

Customers can build multiple data halls in stages and scale both horizontally or vertically. DXN Modular data halls coupled with the DXN Power Modules allows the customer to scale both rack space and power capacity as and when needed.

**Purpose-built prefabricated data centres for EDGE Infrastructure.**

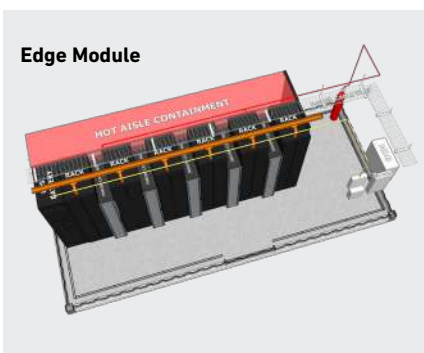
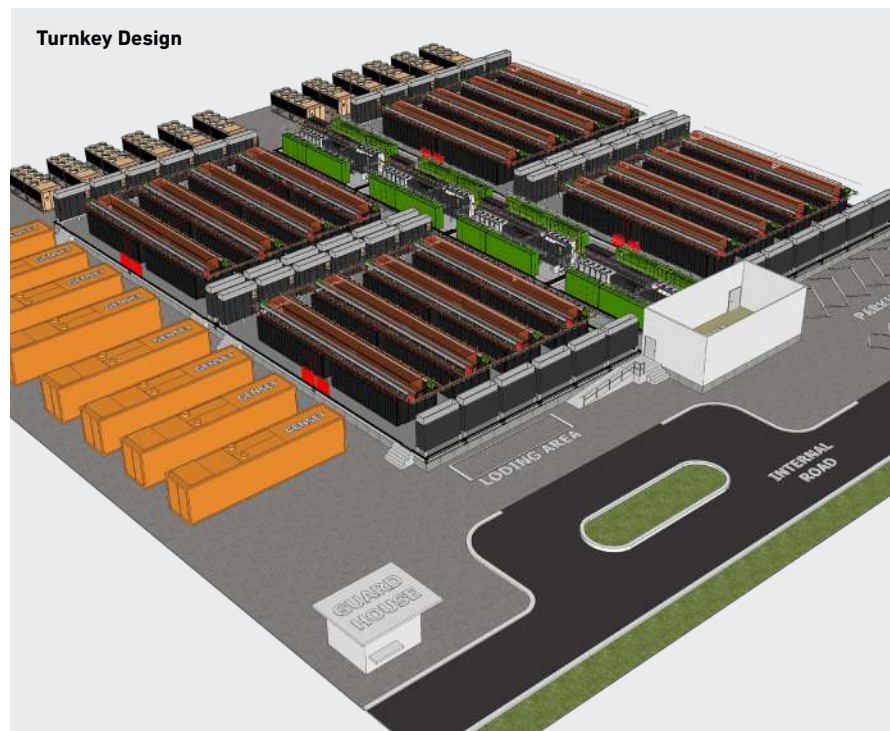
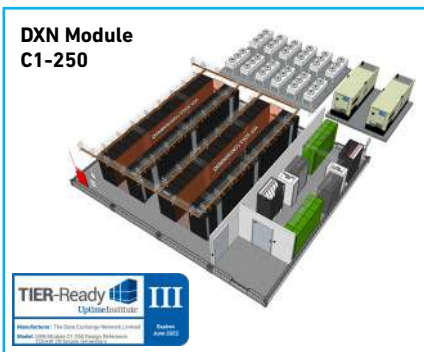
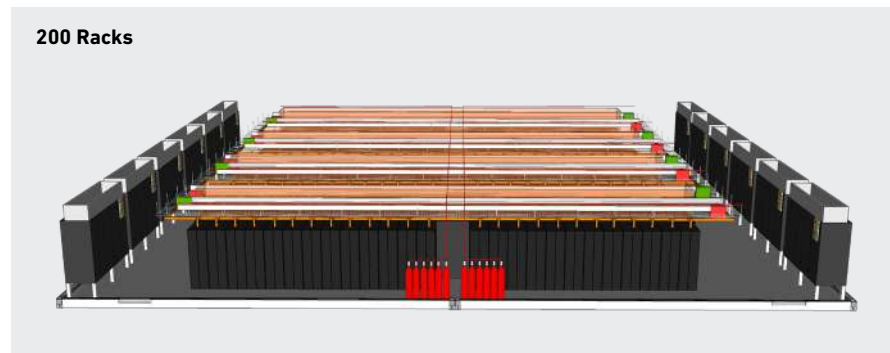

# Datasheet

## Key Highlights of DXN Modules

- Every solution is custom designed for specific customer requirements.
- Designed for any Tier level – Tier III Concurrently Maintainable designs or Tier IV Fault Tolerant design with no single point of failures.
- Complete in-house design and build by DXN Team.
- Vendor agnostic designs that allow customers to choose the vendors they prefer.
- Accelerated time-to-market, less than 24 weeks for a typical project delivered to site.
- Robust high-quality solution designed and built by our Australian based engineering and manufacturing team.
- Desinged and manufactured to last over 20 years in the harshest environments.
- Modular and scalable design allows the customers to keep the initial CAPEX low and scale as and when needed.
- Both remote and on-site maintenance and support



## DXN Modules:

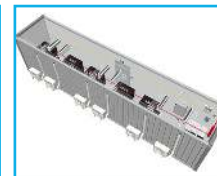
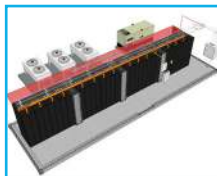

DXN Module Type	DXN Module C1	DXN Module D1	DXN Module A2	DXN Module A1	DXN Module B1
Floor Space in Sqm	42sqm	28sqm	56sqm	28sqm	14sqm
External Dimensions	12.2m (L) x 3.49m (W) x 3.49m (H) standard (Custom height max up to 4mtrs)	8.0m (L) x 3.49m (W) x 3.49m (H)	12.2m (L) x 4.88m (W) x 2.9m (H)	12.2m (L) x 2.44m (W) x 2.9m (H)	6.06m (L) x 2.44m (W) x 3.3m (H)

Heading	Subheading	Description
Design Standards	UpTime Tier level	Tier I to Tier IV standards (standard design for Tier III Concurrently Maintainable upgradable to Tier IV Fault Tolerant)
	TIA-942	Rated 1 to Rated 4 standards
Structural	Corrosion Standards	C4 (standard), C5 and CX options available
	Seismic	Standard Zone 3 (options available for Zone 4 and 5)
	Flooring	Anti-Static vinyl flooring (optional raised floor)
	Thermal Insulation	R-Value from 2.37 up to 5.13
	Cable Entry	Roxtec G Transit IP 66 rated gland plate for all cable and piping entry points
	Lighting	LED Lighting
	Cable Trays/Fibre tray	Separate wire trays for power and structured cabling and optional fibre optic tray with spill-over for each rack



Rapid Deployment  
Modular  
Different

Call 1300 328 239 or email [info@dxn.solutions](mailto:info@dxn.solutions)

For more information visit [www.dxn.solutions](http://www.dxn.solutions)

## Datasheet

Heading	Subheading	Description
<b>Fire Protection</b>	Fire Rating	2hr (120 min) Standard, 1hr (60 min) options available
	Fire Detection	Argonite, Novec 1230, FM-200
	Smoke Detectors & VESDA	Smoke detectors and early warning detection systems included as standard
<b>Cooling</b>	Cooling methods	DX/Chilled Water, indirect free air solutions
	Cooling Distribution	Perimeter, In-Row, wall mounted, rack mounted, top mounted
	Cooling Containment	Hot/Cold aisle containment
<b>Power</b>	UPS System	1kW to 1.2MW per UPS, paralleled up to 4.8MW
	DC System	-48V DC System
	Inverter System	1.5kVA DC to AC modular inverter up to 30kVA
	Transformer	Stepdown transformer or isolation transformer options available
	Low Voltage Distribution Board	380-415V distribution boards with max rating up to 6300A
	ATS	2-way or 3-way Automatic Transfer Switch with integrated control panel
	Genset	Single or synchronized generator system with fuel tank
	Power Distribution	Power cabling to racks using cables with power socket (busbar options with tap off boxes also available)
	Rack PDU	Basic/Metered/Monitored rack PDU
	<b>Monitoring &amp; Management</b>	BMS/DCIM
EMS		Environmental monitoring system to monitor temperature and humidity
<b>Security System</b>	Access System	Card/Keypad/Biometric
	CCTV	Indoor/Outdoor/PTZ/IR Cameras with up to 90 days recording capability
<b>Doors</b>	Entry door	120min fire rated steel doors 1.3m width and 2.3m height (options for 1.8m door available)
	Emergency exit doors	120min fire rated steel doors 0.9m width and 2.3m height